

Radial Thread Rolling

RE-23 - Radial Head

RADIAL THREAD ROLLING HEADS

STANDARD SHANK STYLE ILLUSTRATED
FLANGE MOUNTING ALSO AVAILABLE

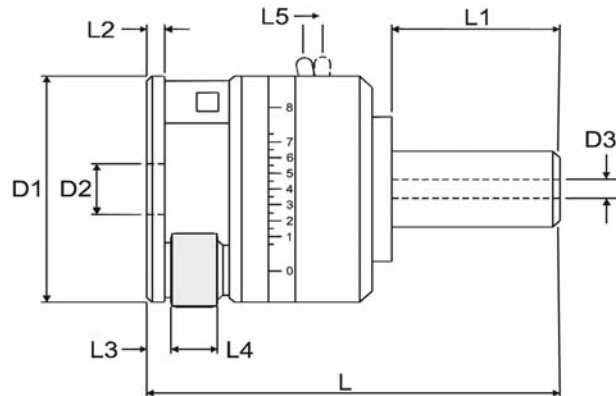

L4 = Maximum width of rolls
L5 = Stroke to trip head

Dimensions

SHANK Ø OPTIONS		D1	D2	D3	L	L1	L2	L3	L4max	L5
2 - 2,1/2	inches	6.693	1.968	0.492	10.295	3.937	0.512	0.520	1.362	0.177
50 - 60	mm	170	50.0	12.5	261.5	100.0	13	13.2	34.6	4.5

The following thread rolls may be ordered as standard on the RE-23 head

ISO Metric

Nominal Size x Pitch mm

M 16 x 1
M 16 x 1.5
M 16 x 2
M 18 x 1
M 18 x 1.25
M 18 x 1.5
M 18 x 2
M 18 x 2.5
M 20 x 1
M 20 x 1.5
M 20 x 2
M 20 x 2.5
M 22 x 1
M 22 x 1.5
M 22 x 2
M 22 x 2.5
M 24 x 1
M 24 x 1.5
M 24 x 2
M 26 x 1.5
M 27 x 2
M 27 x 1.5
M 28 x 1.2
M 30 x 2
M 30 x 1.5

Metric Taper

Nominal Size x Pitch mm

M 16 x 1.5
M 18 x 1.5
M 20 x 1.5
M 22 x 1.5
M 24 x 1.5
M 26 x 1.5
M 27 x 1.5
M 30 x 1.5

Unified

Nominal Size x TPI

5/8 x 11 UNC
5/8 x 18 UNF
5/8 x 24 UNEF
11/16 x 24 UNEF
3/4 x 10 UNC
3/4 x 16 UNF
3/4 x 20 UNEF
13/16 x 20 UNEF
7/8 x 14 UNC
7/8 x 20 UNEF
15/16 x 20 UNEF
1 x 12 UNF
1 x 20 UNEF
1,1/6 x 18 UNEF
1,1/8 x 12 UNF
1,1/8 x 18 UNEF
1,3/16 x 18 UNEF

Whitworth

Nominal Size x TPI

5/8 x 14 BSF
3/4 x 12 BSF
7/8 x 11 BSF
5/8 x 11 BSW
3/4 x 10 SW

Whitworth Pipe BSP

Nominal Size x TPI

G 3/8 x 19
G 1/2 x 14
G 3/4 x 14

Whitworth Pipe BSPT

Nominal Size x TPI

R 3/8 x 19
R 1/2 x 14
R 3/4 x 14

American Pipe Taper

Nominal Size x TPI

3/8 x 18 NPT
1/2 x 14 NPT
3/4 x 14 NPT

American Pipe Dry-Seal

Nominal Size x TPI

3/8 x 18 NPTF
1/2 x 14 NPTF
3/4 x 14 NPTF

The range of sizes shown can normally be safely rolled on the RE-23 head. For thread forms other than those listed, please contact our technical department.

Thread rolls are supplied as standard to suit right hand heads. This refers to the direction of rotation of the spindle and not the thread itself. Both right and left hand threads can be rolled using the same head; only the rolls are changed.